

# MLA Citations

8th edition

## (In Text Citation)

When referring to the work of others in the text of your paper, whether **quoting, paraphrasing, or summarizing** use parenthetical citations.

**For example:**

Human beings have been described as “symbol-using animals” (Burke 3).

**SIGNAL PHRASE:**

**Dr. Atol Burke states** human beings have been described as “symbol-using animals” (3).

Opponents argue any laws implemented to inhibit access to any type of firearm eventually will destroy the second amendment (Smith and Wesson 6).

**Quoting an indirect source:**

Mr. Colt argues “We need to enforce the gun control laws we have” (qtd. in Smith and Wesson 5).

## Authors

**1:** LastName, FirstName. Doe, John A.

**2:** LastName, FirstName, and FirstName LastName. Doe, John A., and Joe K. Box.

**3 or more:** Use first author’s name and the words et al. (and others)  
Lastname, Firstname, et al.  
Doe, John A., et al.

All titles *in a Container* should have “Quotation Marks.”  
“All the Major Words in Any Title Should be Capitalized.”

**ALL CONTAINERS**  
should be  
**ITALICISED**

*Book Title*                      *Newspaper Name*  
*Journal Name*                *Database Name*  
*Magazine Name*              *Website Name*

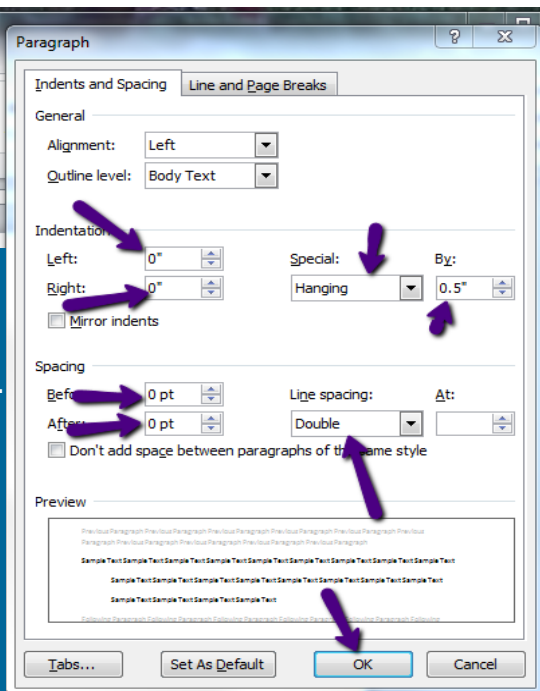
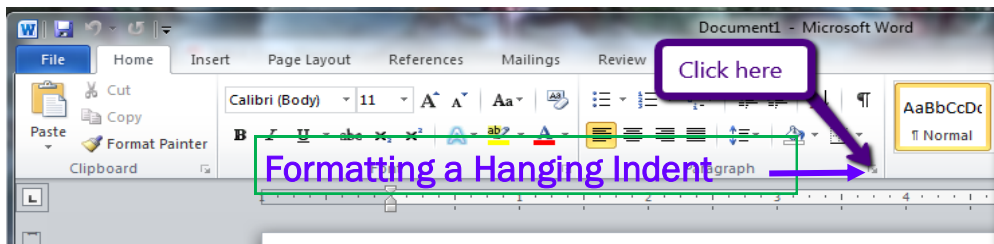

Always double check citations with a MLA style guide!  
**Valencia College Library /MLA Research Guide / MLA 8th ed.**  
OR  
MLA STYLE CENTER – [style.mla.org](http://style.mla.org)  
OR  
**OWL—PURDUE UNIVERSITY**

Elements	MLA 8th Edition Core Elements	Examples
<b>Author.</b> Skip if none listed	1st author Lastname, Firstname. 2 authors Lastname, Firstname M., and Firstname M. Lastname. For 3 or more, et al. after first. Lastname, Firstname, et al. Editor may be used, add, editor. Lastname, Firstname M., editor. For creative works, <b>use focus</b> , e.g. actor’s name or show creator, with performer, actor, and director as other contributors Pseudonyms, such as <b>online handles</b> , may be used as author names. <b>Corporate authors</b> may be used, but <b>skip if the author is also the publisher</b> and just put it in publisher.	
<b>“Title of Source.”</b> “Parts Are Considered the Source.”	Standardize Capitalization and Punctuation. (all major words capitalized) <b>Parts</b> go in “Quotation Marks.” “Title of Article.” “Title of Webpage.” “Title of a Chapter in a Book.” When a source is <b>untitled</b> , provide a description that is neither “ ” nor italicized. e.g. Quote about nature.	
<b>Title of Container,</b>	<i>Books Titles, Periodical Titles, Whole Websites, Databases are Containers.</i> Standardize Capitalization and Punctuation. (All Major Words Capitalized)	
<b>Other contributors,</b>	Translators and editors go here. Use <b>edited by, translated by, before name.</b> e.g. <b>edited by, Sarah Mendez,</b>	
<b>Version,</b>	Editions go here. Use ed., e.g. <b>7<sup>th</sup> ed., or East Coast edition.</b> This is also where you put things like director’s cut for media.	
<b>Number,</b>	Use abbreviations such as <b>vol., no.</b> e.g. <b>vol. 26, no. 4,</b> Season or episode numbers also go in this space.	
<b>Publisher,</b>	<b>Omit for periodicals</b> For university presses, use <b>UP.</b> Oxford UP, U of Washington P For other publishers, write out Press. <b>If multiple, put all divided by /</b> <b>Omit for websites</b> whose title is the <b>same</b> as the publisher.	
<b>Publication Date,</b>	Day Month Year format <b>19 Jan. 2016,</b> abbreviate months except <b>May, June, July</b> For online publications, <b>cite the most meaningful</b> date, e.g. if the article has been reprinted, use the reprint date not the original date. If <b>no date is available</b> for an online publication, <b>use the access date</b> : Accessed 23 July 2016, Use the historical date if the context is important, e.g. the original air date for a tv episode. (p. May use a range of dates for a website developed over time, 1996-2014, Always use the date from the source itself, not a library catalog or Google Books or Amazon	
<b>Location.</b>	For <b>page numbers</b> use <b>p.</b> for a <b>single page p. 6.</b> or <b>pp.</b> for a <b>range pp. 25-40.</b> Use <b>doi</b> for electronic sources, when available. For <b>URLs,</b> <b>omit http://.</b> Use permanent URLs for databases when possible.	

Start over with second *Container* information if needed. A **database** name would be a second **Container**.